

Seniors

SHERLOCK HOLMES





THEMED PROGRAMME



AIM

Journey to 221b Baker Street and the world of Sherlock Holmes and Dr Watson. For this themed programme you'll need to be on top of your game as you tackle murder mysteries, cryptic puzzles and challenging brain teasers. Have you got the brain power needed to find the answers?

ACTIVITIES

-  **There's Been a Murder!**
-  **Sherlock Mysteries**
-  **Giant Cluedo**
-  **Cryptic Objects Hunt**
-  **Open Eyes, Open Mind**

SHERLOCK HOLMES

» INTRODUCTION

Sherlock Holmes is one of the most famous fictional detectives on the planet. Famous for his observation and deductive skills, Holmes was often seen solving the most puzzling mysteries in Victorian London.

Sherlock Holmes first appeared in 1887 in 'A Study of Scarlet' by the Scottish author Arthur Conan Doyle.

In the 130+ years since, Holmes has featured in countless books, comics, stage shows, TV series, films and more.

? DID YOU KNOW?

- Arthur Conan Doyle wrote 56 short stories and 4 novels featuring Sherlock Holmes.
- Sherlock Holmes has featured on TV or film over 250 times, holding the World Record for the most portrayed human literary character in TV & film history.
- Over 100 actors have played Sherlock, including most recently Benedict Cumberbatch (BBC) and Robert Downey Jr (Film).



GET LEARNING: PROBLEM SOLVING THERE'S BEEN A MURDER!

There's been a murder! Sherlock Holmes is busy so you will have to take on this case instead. The details and information you will need are below.

Who has been murdered? Charles James Parker was murdered in his home on 27th June 2021. The body was found in the library by his son George at 10pm. There had been a family dinner party taking place on the night of the murder, attended by 12 people. Charles was last seen at 9pm after dinner, leaving the dining room.

Case Files: You will be given a series of files relating to aspects of Charles' life. Some contain important clues, but others contain red herrings that should be ignored. File 1 was found on the body, the other files have been acquired, compiled or found as part of the investigation. Can you extract the relevant information and not be channelled down a blind alley?

How to run this activity:  Download and print the 'There's Been a Murder' files. Place these in a folder as the 'case files' and hand it to the group taking part. Inside the files are all the clues they will need, however access to the internet to look up a couple of things may be useful. If there are enough young people, split into teams. At the end, see who each team thinks is the murderer and why. The name of the murderer and the reasoning why, can be found on the solution sheet.



GET LEARNING: PROBLEM SOLVING SHERLOCK MYSTERIES

Sherlock Holmes is often called when something strange has happened that no one else can solve. Explore some of these mysteries and see if you can place yourself in the shoes of Sherlock Holmes and solve them yourself?

 Download the 'Sherlock Mysteries' PowerPoint. This can be shown on a projector or large TV. Alternatively the mystery slides could be printed out and used as activity sheets for groups to look at. Go through each mystery and see if you can solve them. The mysteries could be worked on individually, as teams or as a large group. If working in teams, which team can get the most correct?

Example: A bank was robbed and the only witness refuses to talk, only saying they left a clue at the crime scene. The only people with access to the bank vault are Charlie, Dixon, Jason, Janna, Sofia, Patrick and Mark. The only clue found was a year planner on the wall which had 6, 4, 9, 10, 11 written on the front in red pen. Who is the thief?



GET ACTIVE: PLAYING GAMES

GIANT CLUEDO

Take on a classic game of Cluedo, but on a giant scale.



Everything you need for a giant game of Cluedo can be found in the downloadable 'Giant Cluedo' activity pack. This includes:

Set up Instructions: Using 9 tables and 20 cones, you'll be able to create a simplified giant Cluedo board. The activity pack includes an illustration showing you how to create the board. There are also room signs to place on the tables, to help identify each room.

How to Play Rules: We've provided some simplified rules to allow you to play the game of Cluedo slightly quicker than normal. If you've not played Cluedo before, it would be worth reading through the 'normal' rules online first, before playing our simplified version.

Cluedo Playing Cards: Use our suspect, weapons and room cards for your game of giant Cluedo. Alternatively, you could use the real cards from the game if you own the normal sized board game.

Detective Notes: The detective notes sheet will give you somewhere to write down your thoughts as you go along, helping you to discount suspects, weapons & rooms until you have worked out who, what and where.

What you'll need:

- Cluedo Activity Pack (Downloadable)
- 9 Tables
- 20 Cones / Paper / Tape
- Dice
- Envelope
- Pens



GET ACTIVE: PLAYING GAMES

CRYPTIC OBJECTS HUNT

As a detective, Sherlock Holmes must often think outside the box. Put these skills to the test with a cryptic object hunt. For this activity you'll need access to the  'Cryptic Objects' activity sheet. Play this game in one of the below ways.

Team v Team Race: A leader should read out one of the clues. The first team back with the correct object gets a point for their team. (A leader will need to make sure the objects can be found in your meeting space. For those objects that can't be found, the answer should be provided to a leader instead.) Continue playing, keeping a track of the score as you go along.

First to Finish: Each team should be given the sheet of cryptic clues. The first team to have, either as physical objects or written answers, all the correct objects wins.

Quiz: Each team should be given the sheet of clues and use it to write the answers on. After a while go through the answers and see which team has the most correct.

Fastest Finger: A leader should read out a clue. Once a team thinks they know the answer they should 'buzz in' (make a noise, ring a bell etc) to give their answer. One point for a correct guess. Continue playing, keeping a track of the score as you go along.



GET INTO THE BIBLE: MY BIBLE ADVENTURE

OPEN EYES, OPEN MIND

Do we always have our eyes open to the things around us? Or do we often see things but not observe them?

Ask the group how many stairs they have at home? They climb them multiple times a day, but does anyone actually know how many stairs they have? Ask some more tricky observation questions about your meeting space (number of internal doors, rows of chairs in the Church, colour of a sign, curtain pattern etc). How many years have you been coming to your meeting space, but struggle to answer these simple questions? Why is this? Why do we tend to overlook these details? This same question comes up in the Sherlock Holmes story 'A Scandal in Bohemia'.

Holmes: "You have frequently seen the steps which lead up from the hall to this room."

Watson: "Hundreds of times."

Holmes: "Then how many are there?"

Watson: "How many? I don't know!"

Holmes: "Quite so! You have not observed. And yet you have seen. That is just my point. Now, I know that there are seventeen steps, because I have both seen and observed."

When it comes to reading the Bible, listening in Church or taking part in BB devotions, are we just as guilty of sometimes seeing but not observing? Often at BB you will be encouraged to pick up your Bible and read a verse, chapter or story. When you do this are you just reading the words as part of a process, or are you thinking about what they mean and how they impact your life? It's only when we open our eyes and our minds to what we are reading, do we really benefit from opening a Bible.

How can we make sure our eyes are open when we read the Bible? Try asking these three simple questions each time you finish exploring a part of the Bible.

- 1 What is happening?** Retell the story in your own words. Try to sum it up in a sentence.
- 2 What do you learn about God (or man)?** What does the text show you about God's character, love, compassion etc?
- 3 What does this mean to my life?** Take a moment to reflect on how the text applies to you. What can you learn or take away? What is God calling you to do?

Finally, both before and after reading the Bible, Pray. Pray to God and ask him to open your eyes and mind as you explore his word. Ask for his help to see beyond the words to find the meaning.

 **'Your word is a lamp to my feet and a light to my path.' Psalm 119 v 105**



THERE'S BEEN A MURDER!

CASE FILES

Case File 1: Letter

The below is a letter found on the body that was typed on an old fashioned typewriter. Unfortunately the typewriter had a fault and all vowels appear as asterisks, making it difficult to read what has been said.

Ch*rl*s,

M**t m* *n th* l*br*ry *s s**n *s w* h*v* f*n*sh*d d*nn*r.

Y**r p*ck*g* h*s *rr*v*d fr*m th* c*nt*n*nt. Wh*n c*t *t w*ll
h*v* * str**t v*l** *f £500,000.

'v r*sk*d * l*t t* s*c*r* th* d**l.

M*k* s*r* y** k**p y**r s*d* *f th* d**l *nd p*y *p*r
th*r* w*ll b* tr**bl*.

D*n't d* *nyth*ng st*p*d *r y** w*ll r*gr*t *t.

D*sm*nd

THERE'S BEEN A MURDER!

CASE FILES

Case File 2: Charles Parker's June Bank Statement

BANK STATEMENT	
Name: Mr C Parker	Date: 30 th June 2021
Sort Code: 06 - 54 - 17	Account number: 67458989

DD – Direct Debit	DC – Debit Card
SO – Standing Order	ATM – Cash Withdrawal
CR – Credit	CQ - Cheque

Date	Code	Detail	Out (£)	In (£)	Balance (£)
		Balance brought forward			£54350
1 June	DD	EDF Gas	£120		£54230
1 June	DD	EDF Electricity	£90		£54140
1 June	CQ	TD	£3500		£50640
3 June	DC	Rail Ticket	£156		£50484
8 June	DC	Park Regis Hotel Birmingham	£2300		£48184
8 June	DC	The Ivy Temple Row	£460		£47724
11 June	DC	Indulgent Escapes	£7000		£40724
15 June	DC	Garvian Group	£1300		£39424
16 June	DD	LCC CTax	£321		£39103
16 June	DD	George Parker	£1000		£38103
16 June	DD	NFU Insurances	£376		£37727
16 June	CQ	TD	£3500		£34227
24 June	DC	Brownells	£680		£33547
24 June	DC	WAITROSE	£72		£33475
24 June	ATM	Cash withdrawal	£350		£33125
25 June	ATM	Cash Withdrawal	£200		£32925
28 June		Police Pension		£2867	£35792
28 June	Notified of death of Account holder. Account Frozen				
30 June		Closing Balance			£35792

THERE'S BEEN A MURDER!

CASE FILES

Case File 3: Email from Ted Durrell to his Publishers

Send Email

From: Edward.Durrell @ TedsPoems.com

Templates

Book Cover Photos - New Poetry Book

B

I

H

Derick,

Thank you for sending the photographer from your publishers to capture some photos for my new poetry book out at the end of the year.

I've now taken a look through the photos he sent across and I would like to use the photo attached to be used for the 'Meet the Author' section on the back cover.

Thanks again. I'm really looking forward to the book launch later in the year.

Ted



cancel

Send Email

THERE'S BEEN A MURDER!

CASE FILES

Case File 4: Charles Parker's Will

Dear Mr Parker

Wednesday 23rd June 2021

Many thanks for seeing me today and I attach a draft of your updated will. Once approved by you I will draw the engrossment as discussed in readiness for the signing formalities.

Please note that a will only becomes valid once the engrossment is signed and witnessed. We do need therefore to ensure that we complete matters as soon as possible. May I suggest that you come to the office on Wednesday 30th June to sign your will. **Until that time your current will remains in force.**

If for some reason you fail to sign the engrossment document then your current arrangements will apply. In such an event there is clearly a risk that your wishes as outlined when we met may not be complied with.

All addresses of beneficiaries should be regularly updated and kept with the copy will following signing to ensure that the executors have the most recent information available to them in due course and to assist in the administration of the estate.

Using the notation in the draft I would comment as follows:

- 1) **Previous Will/s:** this clause revokes any/all earlier will/s
- 2) **Executors/Trustees:** this clause appoints the named executor/trustee as discussed.

Executors collect the assets and meet the liabilities before distribution and also become involved if the will creates a trust (eg a life interest in the property or a beneficiary under the age specified in the will (see below)). An alternative executor should be considered please.

- 3) **Expression of Wishes:** this clause ensures that you may leave a "note" regarding any small items of sentimental as opposed to an intrinsic value that you wish to leave to specifically-named beneficiaries (eg jewellery et cetera). Where there is a wish to leave an item of substantial value then it ought to appear as a specific gift in the will.

Please ensure that this "note" is updated regularly to reflect your wishes and indeed that it is retained with the copy of the signed will which I will send following execution of the will in due course. It should also include an up to date list of addresses of those named in the will - either as executors/trustees, guardians of infant children and beneficiaries.

- 4) **Cash Gifts:** as per your list.
- 5) **Balance of the Estate:** this deals with the encashment of assets, the settlement of liabilities and then the division of the balance of the estate as per your list.

I have highlighted matters which require your input please and no doubt you can insert the necessary information and e mail it back to me.

Assuming this is approved as drawn please telephone to confirm and I will arrange for the top copy to be ready for signing. If there are any alterations then please speak to me before we meet and I can arrange such in readiness.

I look forward to seeing you on 30th June to finalise this new will.

Finally I attach my invoice for settlement prior to or at our meeting please.

Yours sincerely

Christopher Greenwood
Smith and Ellis Solicitors

THERE'S BEEN A MURDER!

CASE FILES

Case File 4: Charles Parker's Will Continued

THE LAST WILL AND TESTAMENT of CHARLES JAMES PARKER

- 1) I REVOKE all former Wills and Testamentary Dispositions made by me
- 2) I APPOINT ELIZABETH JANE PARKER ("my Trustee") to be the Executor and Trustee of this my Will PROVIDED THAT in the event that she predeceases me or otherwise fails to prove this my will and act in the trusts hereof **then I APPOINT BARRY FENSON to so act**
- 3) I DIRECT but without imposing any obligation that my Trustee/s do have regard to any written expression of my wishes communicated either before or after my death
- 4) I MAKE the following cash gifts:
 - (i) FIVE THOUSAND POUNDS (£5,000.00) to each of my nieces **FIONA KANE, JOANNE SIMMS** and my nephew **JONATHAN KANE**
 - (ii) FIVE THOUSAND POUNDS (£5,000.00) to each of my godchildren namely **WILLIAM BURTON, SIMON BURTON & PIPPA HOWARD**

PROVIDED THAT if any one or more of such beneficiaries in (i) and (ii) shall predecease me then to such of his her or their children as shall so survive and attain the age of twenty one years and if more than one in equal shares
- 5) I GIVE DEVISE AND BEQUEATH all the residue of my property both real and personal whatsoever and wheresoever situate UNTO my Trustee/s to sell call in and convert into money such part or parts thereof as shall not consist of money with power nevertheless for my Trustee/s in their own absolute discretion to postpone such sale calling in and conversion for so long as they shall think fit and with and out of the proceeds of such sale calling in and conversion and with and out of my ready money to pay my debts funeral and testamentary expenses and to stand possessed of the net residue AS FOLLOWS:
 - (i) TEN PERCENT to GRAHAM PIERCE in recognition of his friendship
 - (ii) TEN PERCENT to CURTIS WARREN for services given
 - (iii) THE REMAINDER TO BE DIVIDED EQUALLY BETWEEN MY WIFE ANGELA AND MY YOUNGER SON TIMOTHY. **TO MAKETHIS CLEAR, I REVOKE MY PREVIOUS WILL WHICH LEFT 75 PERCENT OF MY ESTATE TO MY ELDER SON GEORGE.**
- 6) THE standard provisions and special provisions of the Society of Trust and Estate Practitioners (Second Edition) shall apply

IN WITNESS whereof I have hereunto set my hand this day of June Two Thousand and Twenty one.

SIGNED

WITNESS

.....

.....

THERE'S BEEN A MURDER!

CASE FILES

Case File 5: Charles Parker's Family Tree

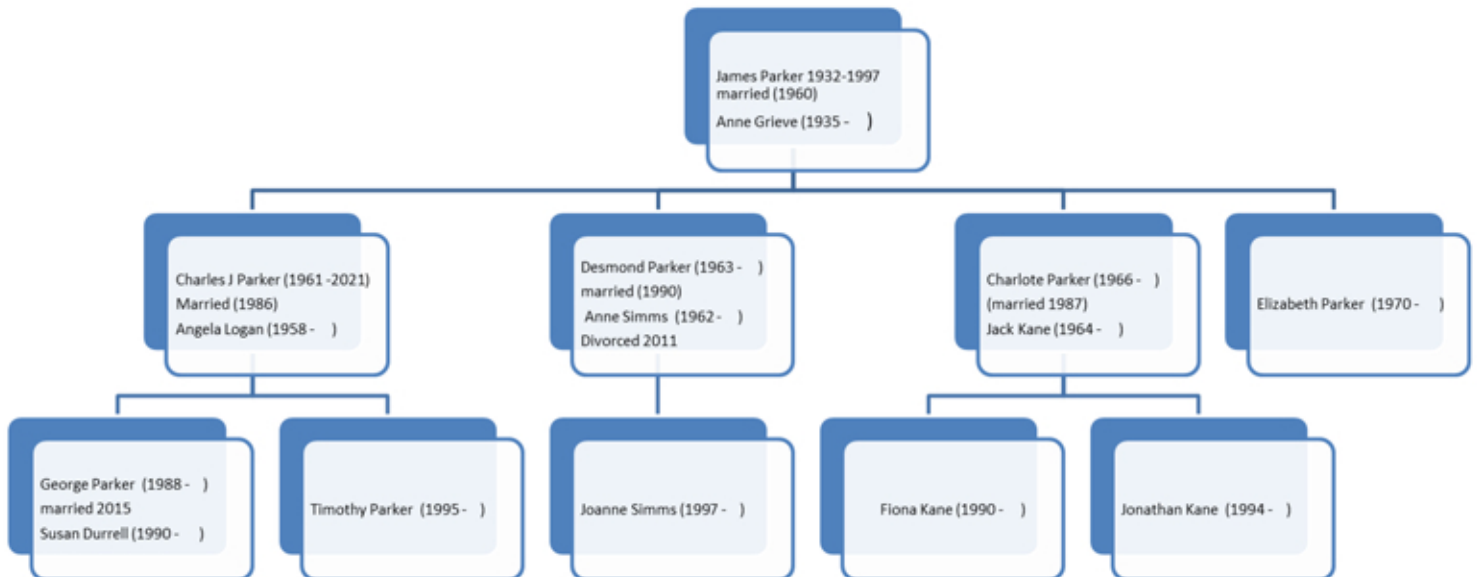

Case File 6: Ground Floor Plan of Charles Parker's Home

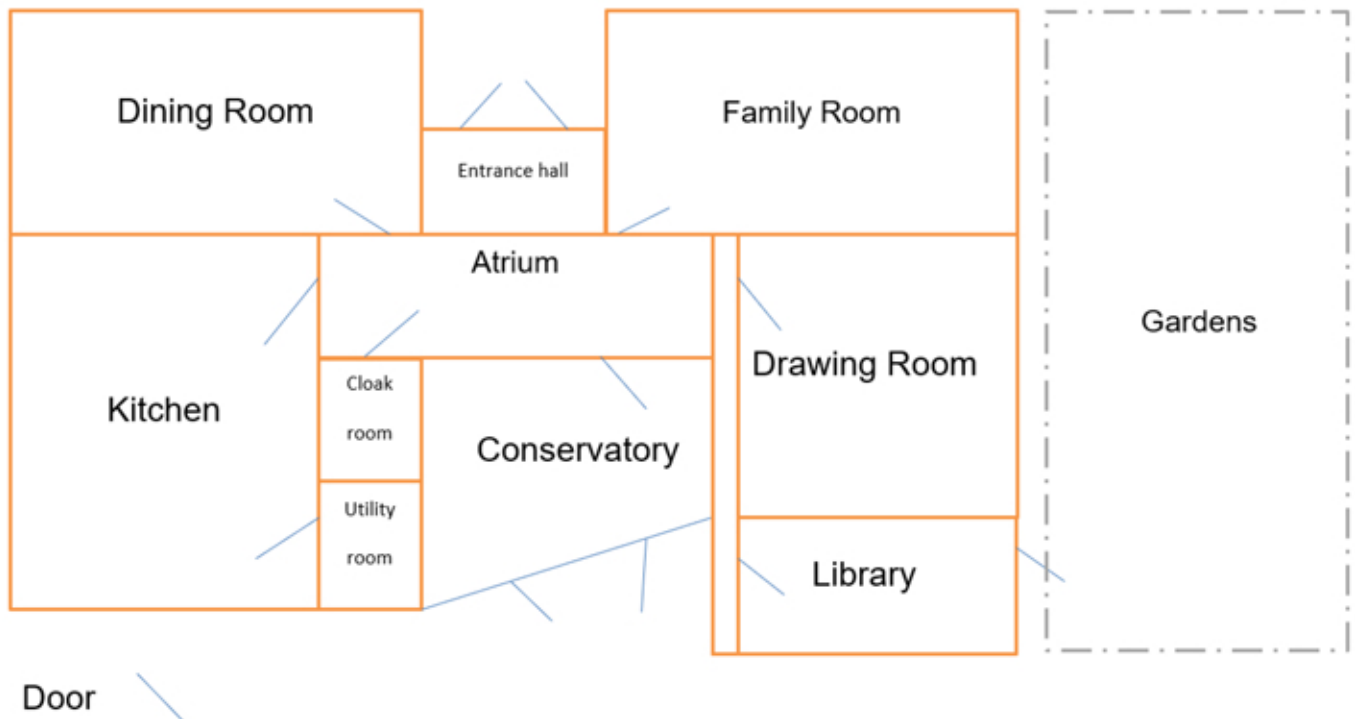

THERE'S BEEN A MURDER!

CASE FILES

Case File 7: Charles Parker's Diary

June 2021

SUN	MON	TUES	WED	THURS	FRI	SAT
		1	2	3	4	5
		TD, make payments of £7,000 pm				
6	7	8	9	10	11	12
Birmingham	Meet Des to finalise deal and discuss problem TD causing	Ivy booked for 7.15			travel agent re Seychelles	
13	14	15	16	17	18	19
		Personal protection Garvian Group				
20	21	22	23	24	25	26
Father's Day		Meeting with TD.	10.30 Chrisopher Greenwood re new Will	11.00 appt at Brownells, Rugby	Lunch with George	Lunch with Elizabeth
27	28	29	30			
Family Dinner at Harewood						

THERE'S BEEN A MURDER!

CASE FILES

Case File 8: Handwritten Letter

	22nd May 2021
CJ	
	I know what you and Desmond are doing and I want a share. My daughter may have married into your family, but that layabout husband of hers is a no hoper, no job, no life, no use.
	He tells me that you give him £1000 a month, but that isn't enough. I want £7000 a month or I'm going to the police and you'll be sent down, just like your friend Curtis and we all know what happens to coppers inside.
Edward	

THERE'S BEEN A MURDER!

CASE FILES

Case File 9: Texts between Charles and George



THERE'S BEEN A MURDER!

CASE FILES

Case File 10: Seating plan for the family dinner on the night of the murder.

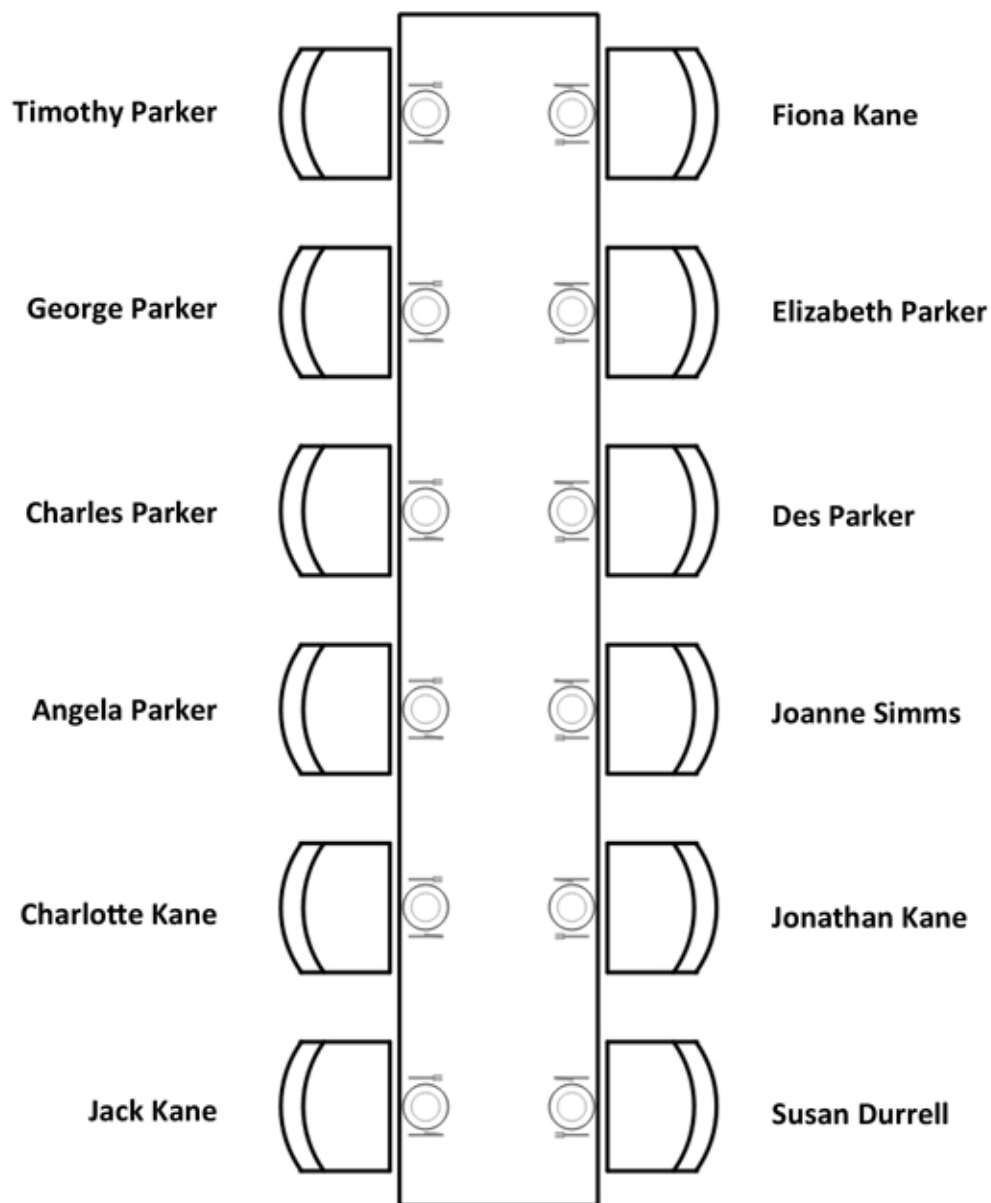

THERE'S BEEN A MURDER!

SOLUTION

The murder was Edward (Ted) Durrell. The below highlights where the clues were in each of the case files.

Case File 1: Letter on the Body

- A threat to Charles made to look like it had come from Desmond (Des). This note asks Charles to go to the library on the night of his murder and where his body was ultimately found.
- The letter shows that Charles and Des were up to something dodgy and beyond the law.
- Everyone calls Des 'Des', apart from Ted who always calls him Desmond.

Case File 2: Bank Statement

- There are bank transfers to TD (Ted Durrell). This is his £7000 he has been demanding.
- There is a £1000 payment to his son George. This is his monthly allowance that he gets.
- Charles spends beyond his means (Police pension). Other income must be coming in from somewhere?
- Garvian group is personal protection. Brownells sells guns. Charles must have either sensed a threat or is involved with something dodgy. It's not clear which (or if both).

Case File 3: Email from Ted Durrell to his Publishers

- This shows that Ted and Edward are the same person. (Ted short for Edward).
- Shows Ted is a writer who owns and uses a typewriter. The letter found on the body was written by a typewriter.

Case File 4: Charles Parker's Will

- Shows that Charles tried to change his will before he was murdered. Not completed (due to be signed on 30th June), so cannot be used now he is dead. The new will cuts out his son George, who was due to inherit 75% of his estate. George would have got nothing. No Charles is dead, he gets the 75%.

Case File 5: Charles Parker's Family Tree

- Highlights that George's wife is a Durrell. Edward (Ted) is George's father in law.

Case File 6: Ground Floor Plan of Charles Parker's Home

- The library (murder site) has an external door to the gardens. The murderer's entrance and exit?

Case File 7: Charles Parker's Diary

- Shows that after meeting Ted, Charles straight away books in to change his will, meet his son and visit a gun store. Did this meeting with Ted start this process?

Case File 8: Handwritten Letter

- Shows Ted had been blackmailing Charles.
- Confirms that Ted is George's father in law.

Case File 9: Texts between Charles and George

- Something has happened that makes Charles need to see his son urgently. The relationship between these two seems amicable.

Case File 10: Seating plan for the family dinner on the night of the murder.

- Red herring. Shows that Ted wasn't at the dinner on the night of the murder, so makes it look less likely to be him. Ted would have known a family dinner was going on and used this to shift suspicion onto Des, who was aware that Ted was causing problems (Diary).

GIANT CLUEDO: SET UP INSTRUCTIONS

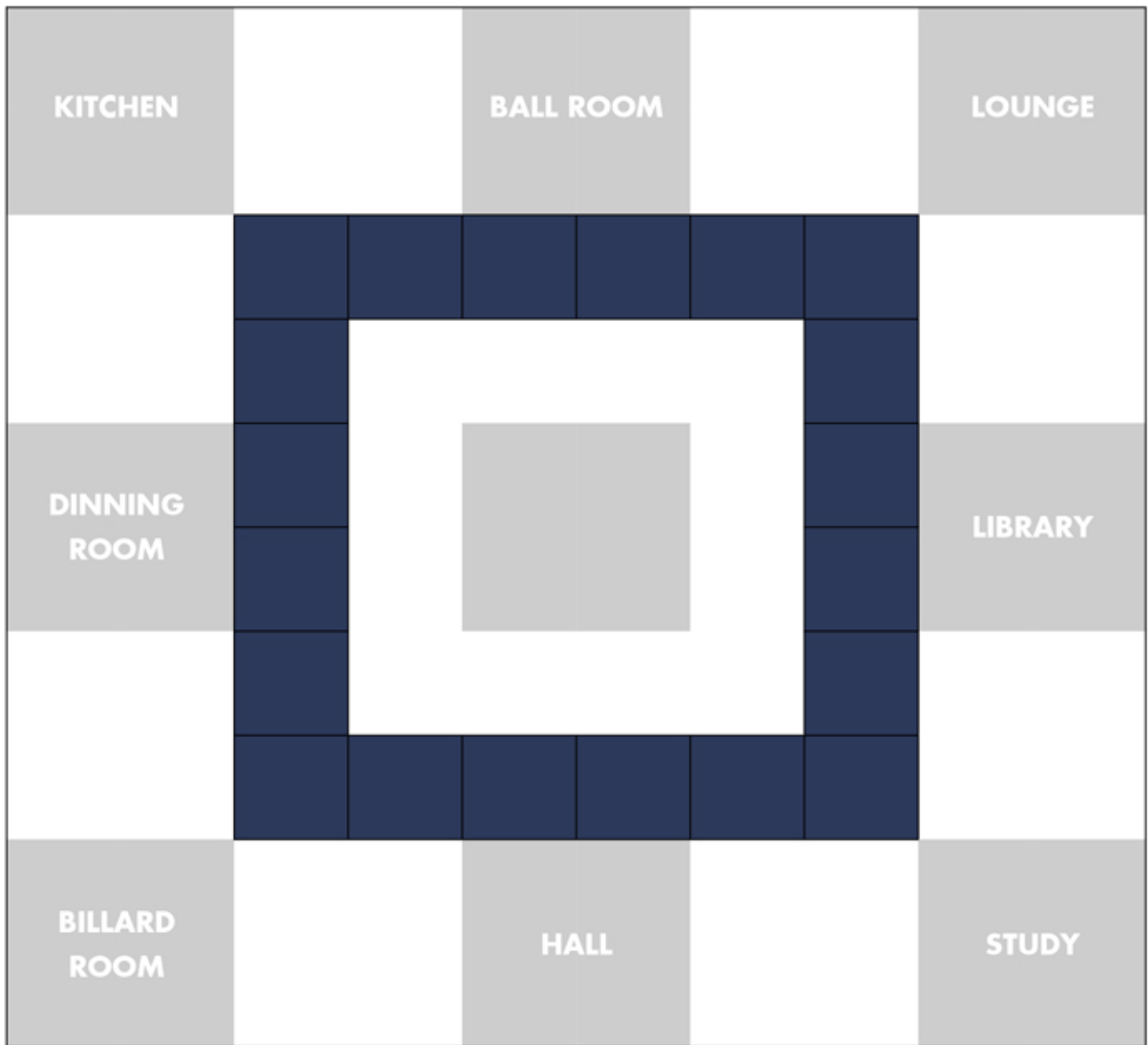

HOW TO SET UP

- This set up creates a simplified Cluedo board, which will allow you to play a giant game in your meeting space.
- Place 9 tables around your room, as per the illustration above. (Grey boxes are tables). The table in the middle is where you can place the sealed envelope with the murder suspect, weapon and room cards.
- Use cones, sheets of paper or tape etc to form the corridor around the room (blue boxes). In total there are 20 squares that link up all the Cluedo rooms (tables).
- Print out the room names or create your own. Place these on the tables, so it's clear which room (table) is which. You could also place objects on the table which represent that room (i.e. books for the library, pots and pans for the kitchen, snooker balls for the billiard room).

GIANT CLUEDO: HOW TO PLAY

HOW TO PLAY

Below are some simplified rules for Cluedo which should allow a quicker game on a giant scale. If you are not familiar with a game of Cluedo, it would be recommended to read the full game rules online first, or watch a tutorial video on YouTube, as the details below are a re-cap of the rules rather than a full description.

BEFORE PLAYING

- You'll need no more than 6 players. If there are more than 6, create pairs / small teams.
- Cut the playing cards into individual cards and divide them into rooms, weapons and suspects piles.
- Shuffle each pile face down and secretly place one of each card into a sealed envelope on the table in the middle of the playing area.
- Shuffle the remaining cards together (still face down) as one pile and deal them all out evenly to the teams playing.
- Teams can cross their cards off on their detective notebooks.

TO PLAY

- Players / teams should choose a tile on the corridor (blue tiles on the illustration) to start from.
- One at a time, players take turns in rolling the die and moving in any direction around the board towards a room. To enter a room, a player must be standing on a blue square that is directly next to the room.
- When moving round the board, any number of players may be on a square or in a room.
- If you enter a room you can immediately make a SUGGESTION. If a player / team is already in a room at the start of a turn they can either:
 - A) Make a SUGGESTION
 - B) Throw the die to move out of the room. If they reach a new room in that throw they can make a SUGGESTION from their new room.

MAKING SUGGESTIONS

- Move a suspect token (i.e a player) and a weapon into the room. If your / your team's token is moved as part of a SUGGESTION you / they must start their next turn from that room.
- Announce "I suspect (Suspect) using (Weapon) in (Room you are in) e.g. I suspect Rev Green in the Hall with the rope.
- Your opponents then try to disprove your suggestion, starting with the player / team on your left. If they have any of the cards you named they show you one only (which you can then cross off on your detective notes). If they have nothing to show the next player / team gets a chance. As soon as one team shows one card the turn is over.

TO MAKE AN ACCUSATION

- You may only make one ACCUSATION per game, so you need to be very sure you know what is in the envelope before you make it.
- Announce "I accuse (Suspect) using (Weapon) in (Room you are in)" and then check the envelope (don't let other players see). If correct, reveal the cards and you / your team has won. If wrong, you become a non-playing character, showing cards when asked, but not taking turns.

GIANT CLUEDO: SUSPECTS CARDS



GIANT CLUEDO: SUSPECTS CARDS

REVOLVER



REVOLVER

DAGGER



DAGGER

CANDLESTICK



CANDLESTICK

ROPE



ROPE

LEAD PIPE



LEAD PIPE

SPANNER



SPANNER

GIANT CLUEDO: ROOM CARDS

KITCHEN



KITCHEN

BALLROOM



BALLROOM

LOUNGE



LOUNGE

DINNING ROOM



DINNING ROOM

LIBRARY





LIBRARY

BILLIARD ROOM



BILLIARD ROOM

GIANT CLUEDO: ROOM CARDS

<div>HALL</div> <div></div> <div>HALL</div>	<div>STUDY</div> <div></div> <div>STUDY</div>	

GIANT CLUEDO: DETECTIVE NOTES

Use your detective notes sheet to mark off the cards as you see them. This should slowly mean you can discount suspects / weapons / rooms until you are confident you know the who, what and where of the murder.

SUSPECTS									
PROFESSOR PLUM									
MISS SCARLETT									
REV GREEN									
MRS PEACOCK									
MRS WHITE									
COL MUSTARD									
WEAPONS									
REVOLVER									
DAGGER									
CANDLESTICK									
ROPE									
LEAD PIPE									
SPANNER									
ROOMS									
KITCHEN									
BALLROOM									
LOUNGE									
DINING ROOM									
LIBRARY									
BILLIARD ROOM									
STUDY									
HALL									

KITCHEN



BALLROOM



LOUNGE



LIBRARY



HALL



WELCOME

STUDY



BILLIARD ROOM



DINING ROOM



CRYPTIC OBJECTS

- 1) I have keys but open no locks, space but no room, I allow you to enter but not to go in?
- 2) What has two hands and a face, but no arms and legs?
- 3) I smash scissors and paper covers me, what am I?
- 4) I am full of holes but I can hold water. What am I?
- 5) The more I dry the wetter I become, what am I?
- 6) Cows swallow this blade, but it's not sharp or metal.
- 7) I have no life, but I can die, what am I?
- 8) I can't be used until I'm broken, what am I?
- 9) I sit in a corner while travelling around the world. What am I?
- 10) When the water comes down, I go up. What am I?
- 11) I have a single eye but cannot see. What am I?
- 12) I am tall when young and short when I am old, what am I?
- 13) I get smaller every time I take a bath, what am I?
- 14) I start with an E, end with an E, and have a letter in me. What am I?
- 15) I cannot be burned in fire or drowned in water, what am I?
- 16) I can fall off a building and live, but put me in water and I will die. What am I?
- 17) I am constantly overlooked by everyone, but everyone has me. What am I?
- 18) I have a head and a tail, but no arms and legs. What am I?
- 19) What starts with a T, ends with a T and has a T in it?
- 20) What has many teeth, but can't bite?

CRYPTIC OBJECTS ANSWERS

- 1) I have keys but open no locks, space but no room, I allow you to enter but not to go in? **Keyboard**
- 2) What has two hands and a face, but no arms and legs? **Clock**
- 3) I smash scissors and paper covers me, what am I? **Rock**
- 4) I am full of holes but I can hold water. What am I? **Sponge**
- 5) The more I dry the wetter I become, what am I? **Towel**
- 6) Cows swallow this blade, but it's not sharp or metal. **Grass**
- 7) I have no life, but I can die, what am I? **Battery**
- 8) I can't be used until I'm broken, what am I? **Eggs**
- 9) I sit in a corner while travelling around the world. What am I? **Stamp**
- 10) When the water comes down, I go up. What am I? **Umbrella**
- 11) I have a single eye but cannot see. What am I? **Needle**
- 12) I am tall when young and short when I am old, what am I? **Candle**
- 13) I get smaller every time I take a bath, what am I? **Soap**
- 14) I start with an E, end with an E, and have a letter in me. What am I? **Envelope**
- 15) I cannot be burned in fire or drowned in water, what am I? **Ice**
- 16) I can fall off a building and live, but put me in water and I will die. What am I? **Paper**
- 17) I am constantly overlooked by everyone, but everyone has me. What am I? **Nose**
- 18) I have a head and a tail, but no arms and legs. What am I? **Coin**
- 19) What starts with a T, ends with a T and has a T in it? **Teapot**
- 20) What has many teeth, but can't bite? **A comb**